

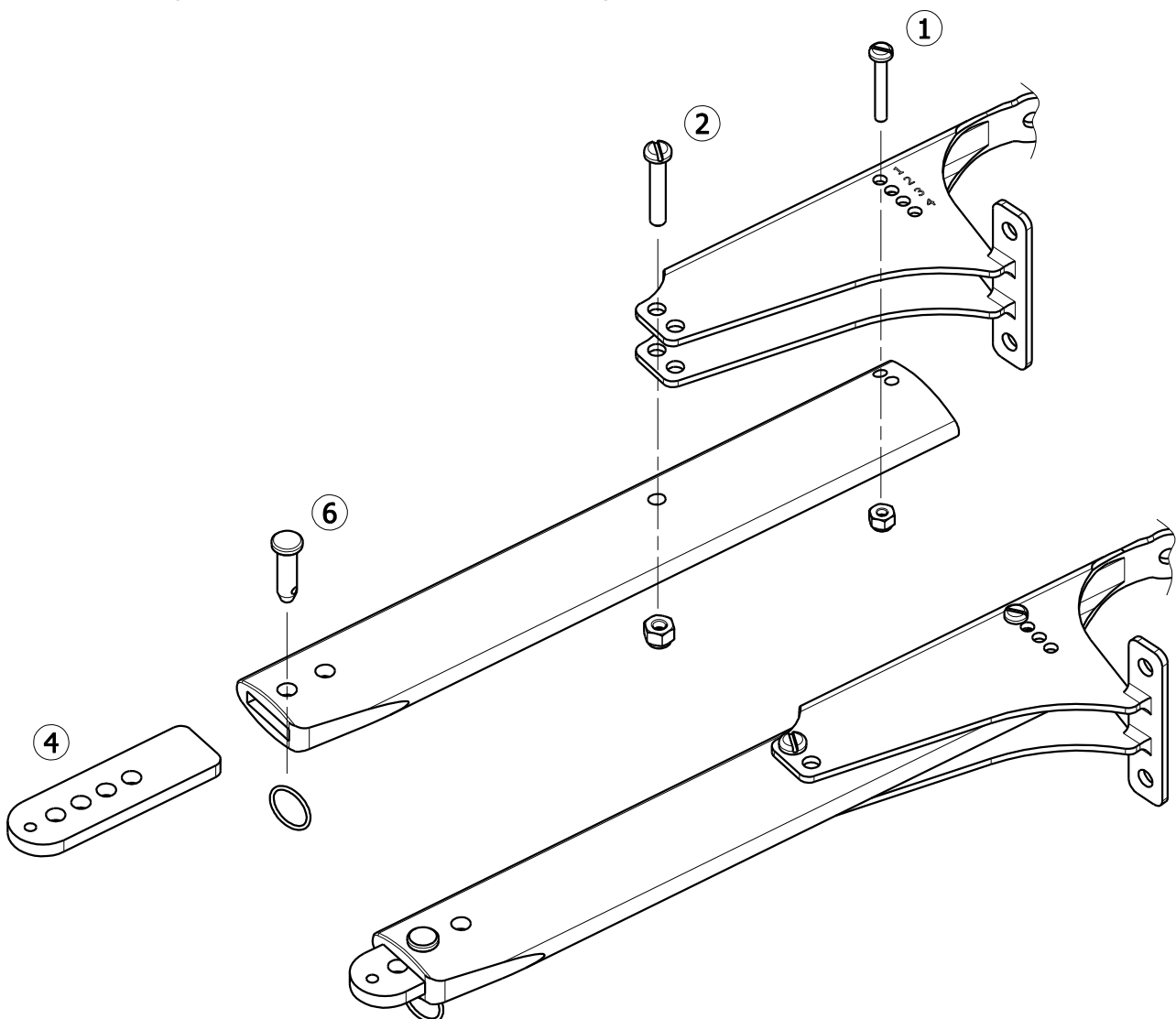

Vernier Spreader Adjustment

Assembly of the Spreader to the Mast Spreader Bracket.

1. Use 3mm screw & nut through forward hole No.1
2. Use 4mm screw & nut through the most forward hole as shown.
3. Do not use hole No.'s 2, 3 or 4
4. The length adjuster can be found attached to the shrouds.
5. At the outboard end of the spreader push the length adjuster into the slot in the end of the spreader.
6. Push the clevis pin through the spreader locating the length adjuster plate as shown & secure with the clevis ring.
7. Please make sure that the holes used for assembly match those shown in the illustration.
8. All clevis pins, rings, nuts & screws must be covered with self amalgamating tape (electrical or PVC tape is best). This will reduce chafing on the mainsail and avoid damage.



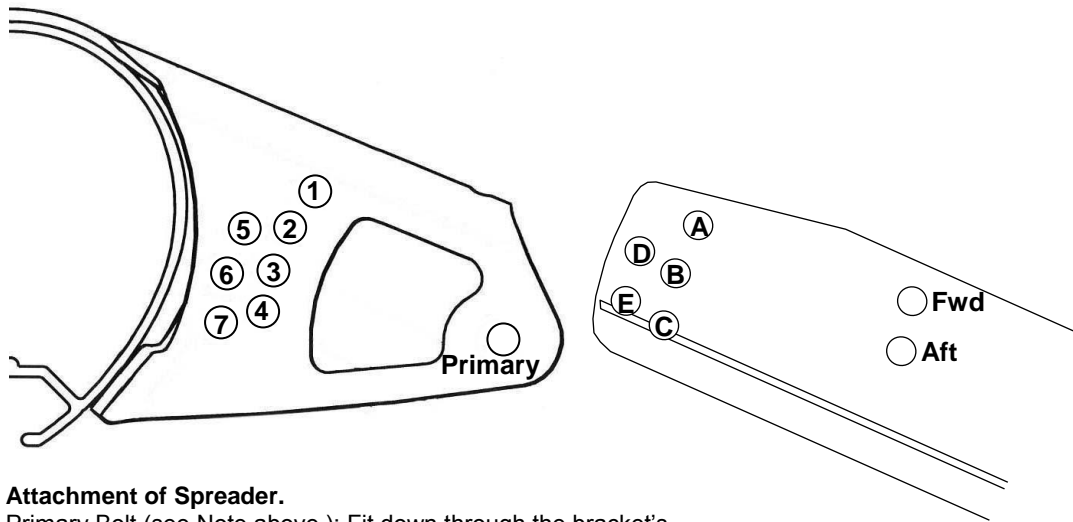

Attachment of Spreader.

Primary Bolt (see Note above): Fit down through the bracket's Primary hole and the Fwd or Aft spreader hole as required.

Adjuster Pin: Fit down through a hole 1 to 4, and through A to C or through a hole 5 to 7, and through D to E.

Please see the table below for your class specific positions.

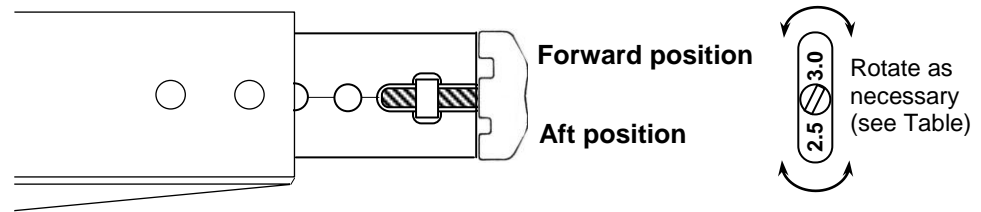

Spreader Ends

Spreader End Cap:

The spreader end cap incorporates two shroud wire slots to give a tight grip on either 2.5 or 3mm wire. The sizes are identified on the front face of the end cap (See diagram above). To find which wire slot you require for your mast, please see the table below.

The end cap can also be rotated so that the shroud can be positioned at either the forward or aft position of the spreader end (see diagram above). To find out which position is required for your mast, please see the table below.

To attach the shroud, slacken the end screw, rotate the end clamp if necessary, then insert the shroud. Ensure that the shroud is tensioned between T-Terminal and spreader tip, then tighten the screw firmly. This method "locks in" the dihedral angle.

Length Adjustment:

The position is described by the number of adjustment holes visible (e.g. In the diagram above there are 1 ½ holes visible). **Please see the table below for your class specific positions.**

Security

All clevis pins must be fitted with the flat head on top, and locked with a split ring. Tape all split rings, pins and the outboard end of the spreader extrusion. This will reduce chafe on the mainsail and prevent flailing sails/halyards becoming damaged.

Self-amalgamating tape is best, but pvc electrical tape is an adequate alternative.

Class	Bracket Connection		Outer End		
	Primary Bolt	Adjuster Pin	End cap pos'n	Wire Dia.	Visible Holes
Topaz	Aft	1A	Aft	2.2mm	2
Vibe	Aft	1A	Aft	3.0mm	2
Magno	Aft	1A	Aft	3.0mm	2
Omega	Aft	1A	Aft	3.0mm	2
Xenon	Aft	1A	Aft	3.0mm	2
Argo	Aft	1A	Aft	3.0mm	4½